

## WS 6215-LED-ELVT-1-DW The LED Wedge™

## WEDGE™ LED DIM TO WARM INSTALLATION INSTRUCTIONS

### READ ALL INSTRUCTIONS CAREFULLY

**CAUTION:** DISCONNECT POWER SUPPLY BEFORE INSTALLATION  
**CAUTION:** RISK OF FIRE:  
Most dwellings built before 1985 have supply wire  
rated 60°C.  
Consult a qualified electrician before installing.

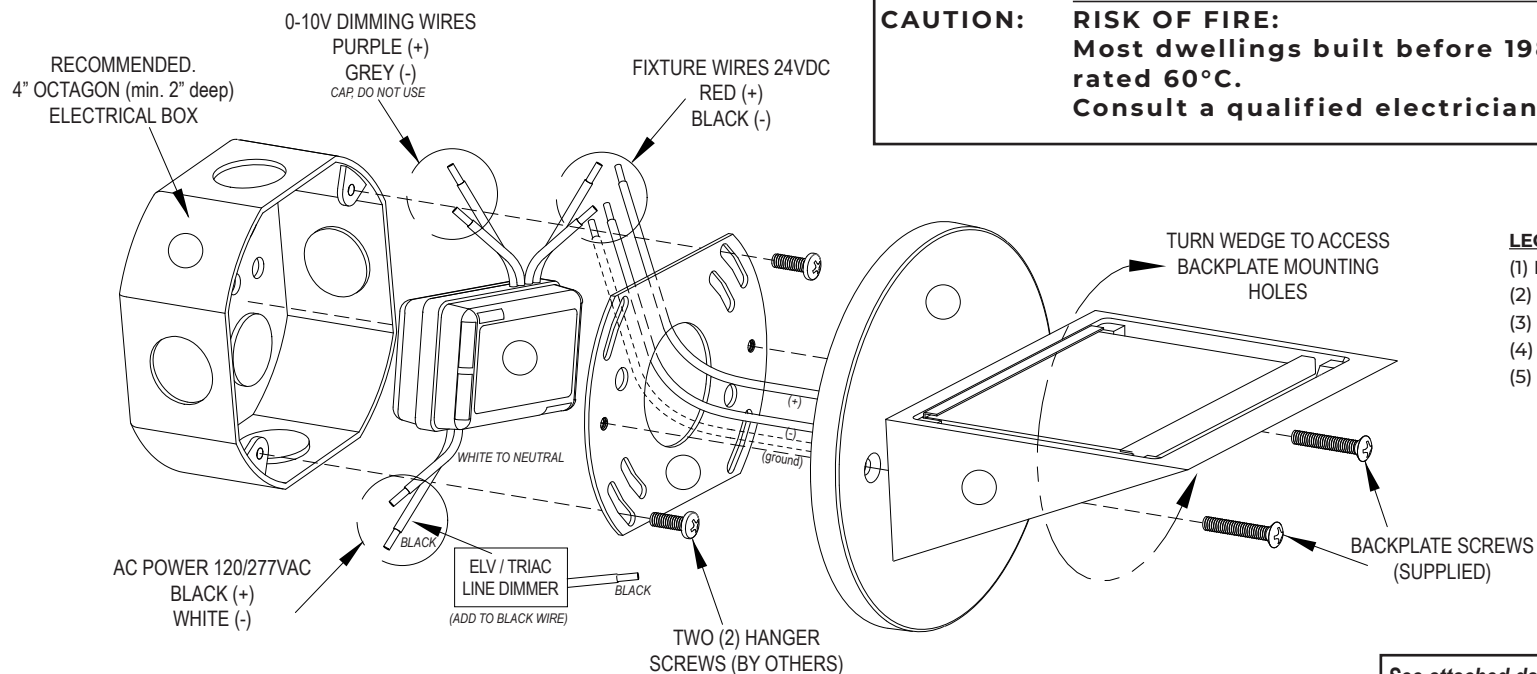

### LEGEND

- (1) FIXTURE
- (2) BACKPLATE
- (3) HANGER BAR
- (4) LED POWER SUPPLY
- (5) ELECTRICAL BOX (BY OTHERS)

See attached data sheet for additional dimming details

## FIXTURE INSTALLATION

THIS PRODUCT MUST BE INSTALLED IN ACCORDANCE WITH THE APPLICABLE INSTALLATION CODE BY A PERSON FAMILIAR WITH THE CONSTRUCTION AND OPERATION OF THIS PRODUCT AND THE HAZARDS INVOLVED.

### STEP 1: TURN OFF THE POWER SUPPLY TO THE ELECTRICAL BOX

Recommended 4" octagonal electrical box, 2" min deep (#4)

### STEP 2: WIRE LED POWER SUPPLY

- Wire main AC power (120VAC) to LED Power Supply (#4). White (-), Black (+), Green (Ground)

#### FOR NON DIMMING

- Cap the Purple and Gray Wires. These wires may be shortened.

#### FOR DIMMING

This fixture is compatible with LED ELV or TRIAC dimmer switches at 120VAC ONLY.  
The dimmer switch wires must be in place or installed and routed into the electrical box.

- Connect the Black (+) wire to the dimming switch's Black (+) wire.
- Cap and shorten the Purple and Gray wires. These wires may be shortened.
- Insert the LED Power Supply (#4) into the electrical box (#5)

### STEP 3: INSTALL THE HANGER BAR

- Pull the Red (+) and Black (-) wires from the LED Power Supply (#4) thru the hanger bar (#3) center hole.
- Attach the hanger bar (#3) to the Electrical Box (#5) with the two (2) screws that come with the electrical box (supplied by others).

### STEP 4: WIRE THE LED FIXTURE

- Connect the Red (+) and Black (-) wires from the LED power supply (#4) to the Red (+) and Black (-) fixture wires.
- "Tuck" the wires thru the hanger bar (#3) center hole into the electrical box.

### STEP 5: INSTALL THE FIXTURE

The Wedge Fixture can be turned to access the mounting holes.

- Grasp the backplate (#2), then turn the Fixture (#1)
- Install with the supplied screws, then turn the Fixture (#1) back to the horizontal position.

### STEP 6: TURN THE POWER ON

PO BOX 2079, OCEAN NJ 07712

(732)493-2666 SALES@BELFER.COM

COPYRIGHT© BELFER LIGHTING. NO RIGHTS ARE GRANTED FOR REPRODUCTION, DISCLOSURE OR USE.

PROUDLY MADE IN THE USA

P-1719-02 030122 ESB



## DESCRIPTION

The Cielo series of LED drivers generate one constant current output from an AC input. Dual Dimming allows the Cielo high efficiency drivers to be used with compatible 0-10V or TRIAC/ELV dimmers.



## KEY FEATURES

- 120/220-240/277V<sub>AC</sub> Input
- Dims with TRIAC and ELV dimmers at 120V<sub>AC</sub> only
- Dims with industry standard 0-10V dimmers (108-305V<sub>AC</sub>)
- Max Output Power: 10W to 50W
- 2 case sizes, 10-30W and 40-50W
- Efficiency up to 84%
- 90°C Top case rated
- <20% THD, >0.9 PF
- Fast start up time
- UL 8750 Approved, UL LED Class 2 outputs
- Class II isolation
- Long Life
- RoHS Compliant



## APPLICATIONS AND BENEFITS

Cielo LED drivers are designed for powering LED luminaries using standard lighting controls. Their discreet size easily fits into the space constrained LED fixtures of today's growing Commercial, Residential and Architectural lighting markets.

The modules operate with:

- Standard Light Switches
- 0-10V Dimmers
- Triac based Incandescent Dimmers (Forward phase – leading edge)
- Electronic Low Voltage Dimmers (Reverse Phase – trailing edge)

The following diagram depicts a typical installation utilizing the Cielo:

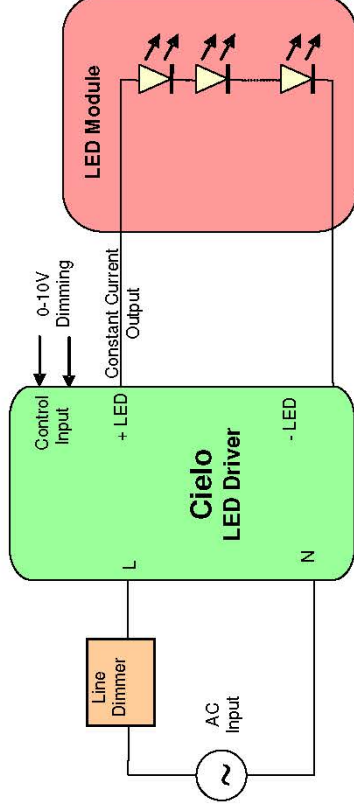

### Cielo's Dimming Options:

- Analog Dimming (0-10V) input provides 10-100% lout Dimming
- AC line dimming from Triac or ELV dimmers (120V<sub>AC</sub>)
- Dimming range down to less than 1C nominal output current