

2"x2" SURFACE MOUNT CANDELABRA BASE INCANDESCENT MARQUEE™ STRIP

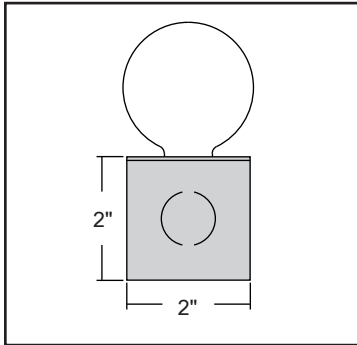

CROSS SECTION

PROJECT

TYPE

CATALOG#

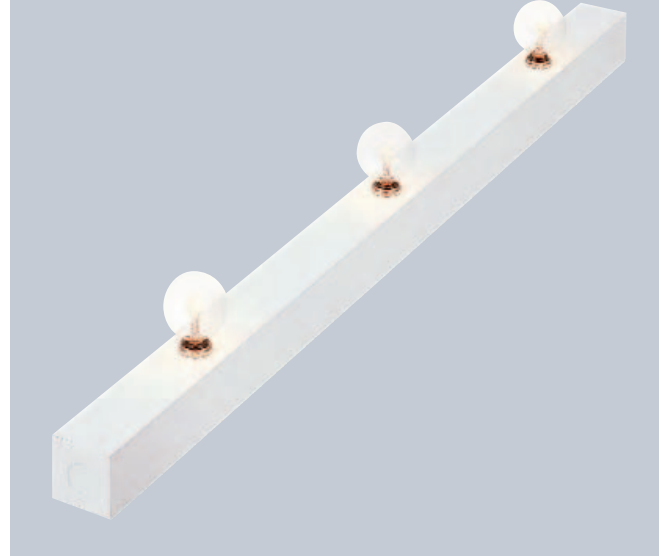

- Straight or Mitered cut as per specification
- Candelabra base sockets
- Candelabra Base Lamp to 60 Watt
- Lamp Spacing Options:
 - 6" On Center
 - 12" On Center
 - Custom Lamp Spacing Available
- Constructed of Extruded Aluminum
- Standard Finish Options:
 - Satin Aluminum
 - White Powder Coat
 - Black Powder Coat
 - Custom Finishes are Available
- Order by the Foot
- UL and CUL Listed Damp Location.

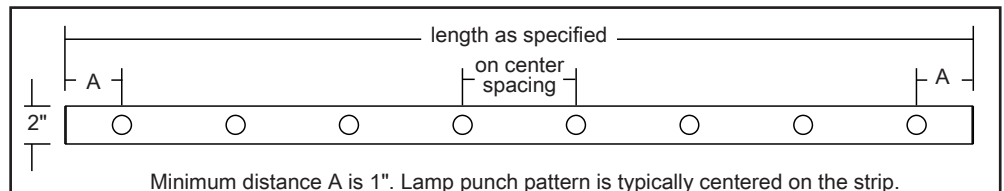

ACCESSORIES AND FABRICATION SHEETS

- A complete line of optional accessories such as baffles, lamp guards, multi-circuiting, decorative end caps and Decora switches and outlets are available. See Accessory Sheet
- Mitered Corner cuts require fabrication information at time of released order. See Mitered Fabrication sheet.
- Custom Baffles can be manufactured to your specifications. See Custom Baffle Fabrication Sheet.

Ordering Format *choose one from each category*

SERIES	LAMP SPACING	FINISH	STRAIGHT or MITERED
MQ 2501 Marquee	<input type="checkbox"/> 6 6" on center	<input type="checkbox"/> SA Satin Aluminum	<input type="checkbox"/> F Straight Footage
	<input type="checkbox"/> 12 12" on center	<input type="checkbox"/> WP White Powder Coat	<input type="checkbox"/> FM Mitered Footage Mitered applications require a fabrication sheet.
		<input type="checkbox"/> BP Black Powder Coat	
		<input type="checkbox"/> CC Custom Color	



Modifications and custom configurations are available. Please contact our Sales Department.

2"x2" SURFACE MOUNT MEDIUM BASE INCANDESCENT MARQUEE™ STRIP

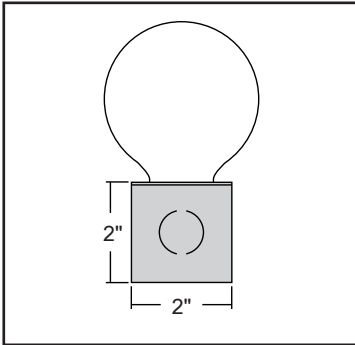

CROSS SECTION

- Straight or Mitered cut as per specification
- Medium Base Sockets
- Lamp Options:
 - A Lamps to 75 Watt
 - G25 or G40 to 60 Watt
 - PAR Lamps to 50 Watt
- Lamp Spacing Options:
 - 6" On Center
 - 12" On Center
 - Custom Lamp Spacing Available
- Constructed of Extruded Aluminum
- Standard Finish Options:
 - Satin Aluminum
 - White Powder Coat
 - Black Powder Coat
 - Custom Finishes are Available
- Order by the Foot
- UL and CUL Listed Damp Location
- Available UL and CUL Wet Location

CAUTION:

Reflectorized lamps can generate significant heat. Be sure to maintain adequate clearance between lamp and combustible materials.

PROJECT

TYPE

CATALOG#

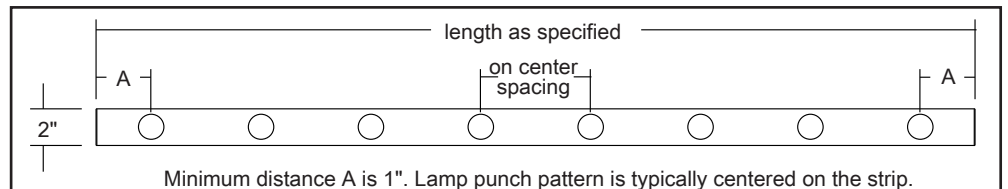

ACCESSORIES AND FABRICATION SHEETS

- A complete line of optional accessories such as baffles, lamp guards, multi-circuiting, decorative end caps and Decora switches and outlets are available. See Accessory Sheet.
- Mitered Corner cuts require fabrication information at time of released order. See Mitered Fabrication sheet.
- Custom Baffles can be manufactured to your specifications. See Custom Baffle Fabrication Sheet.

Ordering Format *choose one from each category*

SERIES	LAMP SPACING	FINISH	STRAIGHT or MITERED	SUFFIX
MQ 2502 Marquee	<input type="checkbox"/> 6 6" on center <input type="checkbox"/> 12 12" on center	<input type="checkbox"/> SA Satin Aluminum <input type="checkbox"/> WP White Powder Coat <input type="checkbox"/> BP Black Powder Coat <input type="checkbox"/> CC Custom Color	<input type="checkbox"/> F Straight Footage <input type="checkbox"/> FM Mitered Footage Mitered applications require a fabrication sheet.	<input type="checkbox"/> WL Specify WL Suffix for Wet Location UL and CUL Damp Location is standard and does not require a suffix



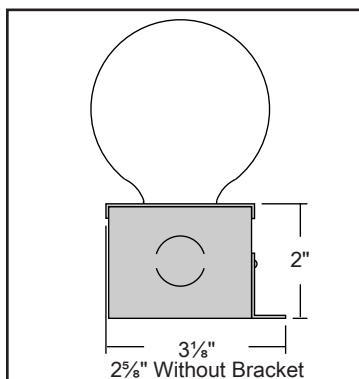

CROSS SECTION

- Field Curvable Marquee
- Medium Base Sockets
- Lamp Options:
 - A Lamps to 75 Watt
 - G25 or G40 to 60 Watt
 - PAR Lamps to 50 Watt
- Lamp Spacing Options:
 - 6" On Center
 - 12" On Center
 - Custom Lamp Spacing Available
- Constructed of formed aluminum
- Satin Aluminum Finish Standard
- Custom Finishes are Available
- Order in 4 foot sections
- UL and CUL Listed Lamp Location

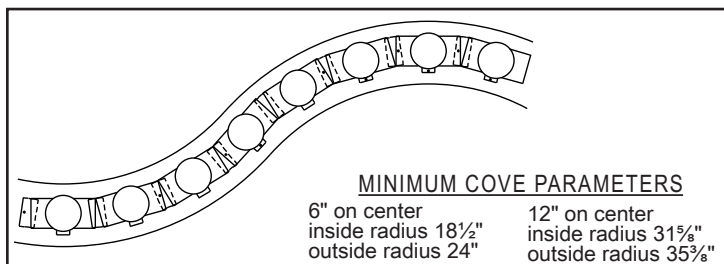

PROJECT

TYPE

CATALOG#



CAUTION:
Reflectorized lamps can generate significant heat. Be sure to maintain adequate clearance between lamp and combustible materials.

ACCESSORIES AND FABRICATION SHEETS

- A complete line of optional accessories such as baffles, lamp guards, multi-circuiting, decorative end caps and Decora switches and outlets are available. See Accessory Sheet
- Custom Baffles can be manufactured to your specifications. See Custom Baffle Fabrication Sheet.

Ordering Format choose one from each category

SERIES	LAMP SPACING	FINISH	LENGTH
MQ 2502FX2 Field Curvable Marquee	<input type="checkbox"/> 6 6" on center	<input type="checkbox"/> SA Satin Aluminum	<input type="checkbox"/> 48 48" Length
	<input type="checkbox"/> 12 12" on center	<input type="checkbox"/> CC Custom Color	



Modifications and custom configurations are available. Please contact our Sales Department.

These products protected by one or more of the following U.S. Patent Numbers 5,448,460, 5,221,139 & 5,452,187. Other patents pending.

1 1/2" x 1 1/2" SURFACE MOUNT CANDELABRA BASE INCANDESCENT MARQUEE™ STRIP

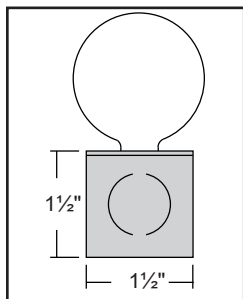

CROSS SECTION

- Straight or Mitered
- Candelabra Base Sockets
- Candelabra Base Lamp to 60 Watt
- Lamp Spacing Options:
 - 6" On Center
 - 12" On Center
 - Custom Lamp Spacing Available
- Constructed of Extruded Aluminum
- Standard Finish Options:
 - Satin Aluminum
 - White Powder Coat
 - Black Powder Coat
 - Custom Finishes are Available
- Order by the Foot
- UL and CUL Listed Damp Location

PROJECT

TYPE

CATALOG#

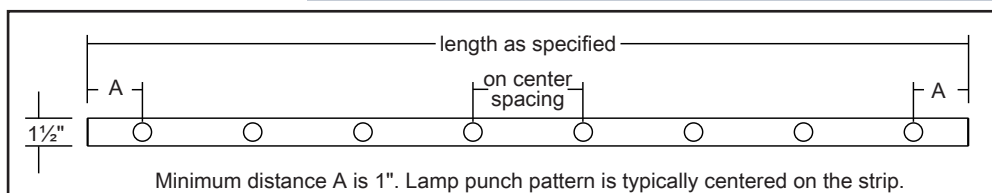
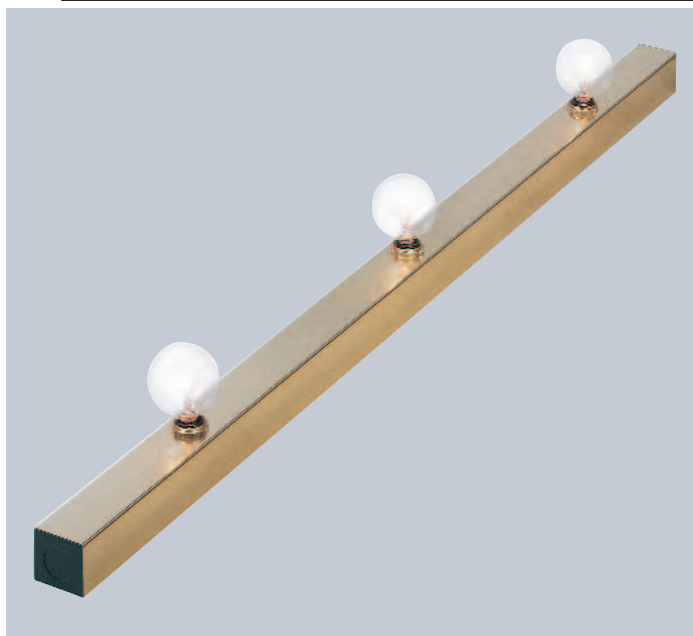

ACCESSORIES AND FABRICATION SHEETS

- A complete line of optional accessories such as baffles, lamp guards, multi-circuiting, decorative end caps and Decora switches and outlets are available. See Accessory Sheet
- Mitered Corner cuts require fabrication information at time of released order. See Mitered Fabrication sheet.
- Custom Baffles can be manufactured to your specifications. See Custom Baffle Fabrication Sheet.

Ordering Format *choose one from each category*

SERIES	LAMP SPACING	FINISH	STRAIGHT or MITERED
MQ 2503 Marquee	<input type="checkbox"/> 6 6" on center	<input type="checkbox"/> SA Satin Aluminum	<input type="checkbox"/> F Straight Footage
	<input type="checkbox"/> 12 12" on center	<input type="checkbox"/> WP White Powder Coat	<input type="checkbox"/> FM Mitered Footage Mitered applications require a fabrication sheet.
		<input type="checkbox"/> BP Black Powder Coat	
		<input type="checkbox"/> CC Custom Color	



Modifications and custom configurations are available. Please contact our Sales Department.

2"x2" RECESSED WITH 3" FACE
MEDIUM BASE INCANDESCENT
MARQUEE™ STRIP

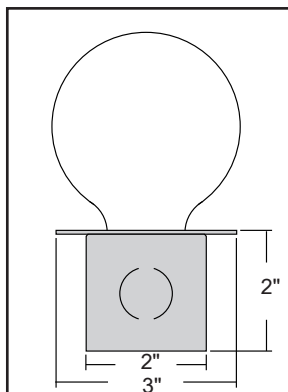

CROSS SECTION

- Straight or Mitered
- Medium Base Sockets
- Lamp Options:
 - A Lamps to 75 Watt
 - G25 or G40 to 60 Watt
 - PAR Lamps to 50 Watt
- Lamp Spacing Options:
 - 6" On Center
 - 12" On Center
 - Custom Lamp Spacing Available
- Constructed of Extruded Aluminum
- Standard Finish Options:
 - Satin Aluminum
 - White Powder Coat
 - Black Powder Coat
 - Custom Finishes are Available
- Order by the Foot
- UL and CUL Listed Damp Location
- Available UL and CUL Listed Wet Location

ACCESSORIES AND FABRICATION SHEETS

- A complete line of optional accessories such as baffles, lamp guards, multi-circuiting, decorative end caps and Decora switches and outlets are available. See Accessory Sheet
- Mitered Corner cuts require fabrication information at time of released order. See Mitered Fabrication sheet.
- Custom Baffles can be manufactured to your specifications. See Custom Baffle Fabrication Sheet.

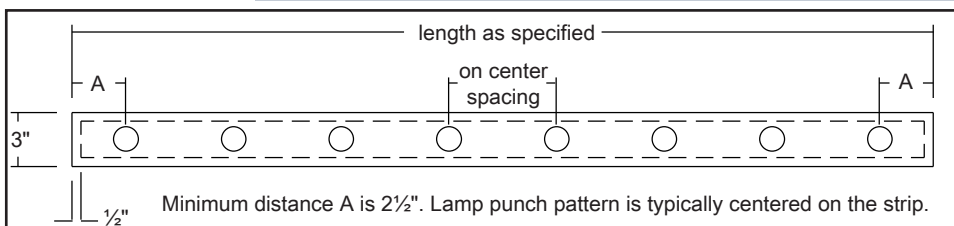
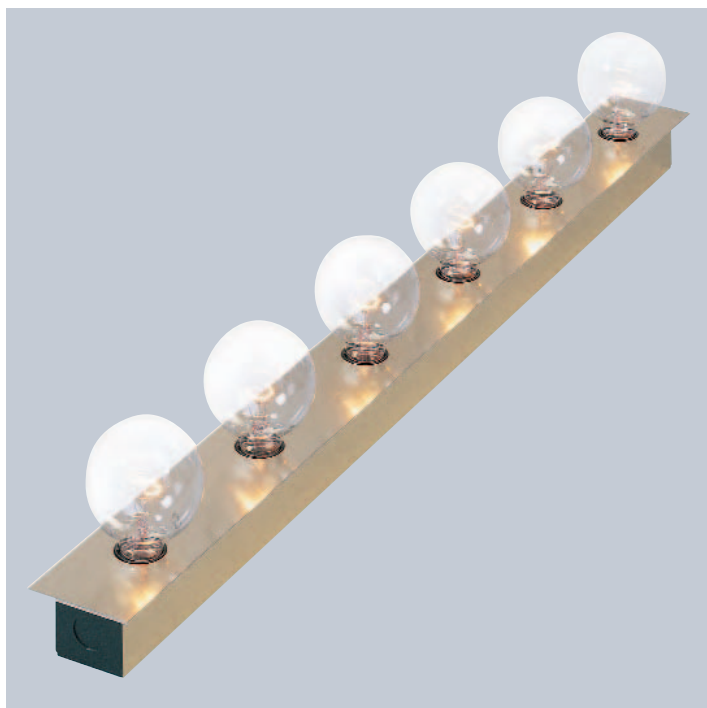

The MQ 2504 is supplied with a faceplate that overlaps the recessed body by 1/2" on all four sides. Bodies are shipped 1" shorter than specified length.

Ordering Format choose one from each category

SERIES	LAMP SPACING	FINISH	STRAIGHT or MITERED	SUFFIX
MQ 2504 Marquee	<input type="checkbox"/> 6 6" on center	<input type="checkbox"/> SA Satin Aluminum	<input type="checkbox"/> F Straight Footage	<input type="checkbox"/> WL Specify WL Suffix for Wet Location
	<input type="checkbox"/> 12 12" on center	<input type="checkbox"/> WP White Powder Coat	<input type="checkbox"/> FM Mitered Footage Mitered applications require a fabrication sheet.	UL and CUL Damp Location is standard and does not require a suffix
		<input type="checkbox"/> BP Black Powder Coat		
		<input type="checkbox"/> CC Custom Color		



Modifications and custom configurations are available. Please contact our Sales Department.

BELFER LIGHTING

TOOLS FOR THE LIGHTING PROFESSIONAL

MQ 2505

2"x2" RECESSED WITH 3" FACE
CANDELABRA BASE INCANDESCENT
MARQUEE™ STRIP

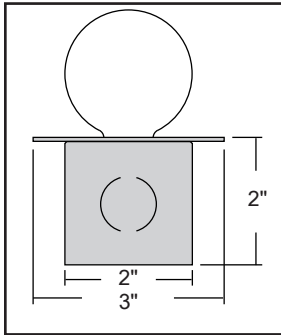

CROSS SECTION

- Straight or Mitered
- Candelabra Base Sockets
- Candelabra Base Lamp to 60 Watt
- Lamp Spacing Options:
 - 6" On Center
 - 12" On Center
 - Custom Lamp Spacing Available
- Constructed of Extruded Aluminum
- Standard Finish Options:
 - Satin Aluminum
 - White Powder Coat
 - Black Powder Coat
 - Custom Finishes are Available
- Order by the Foot
- UL and CUL Listed Damp Location

PROJECT

TYPE

CATALOG#

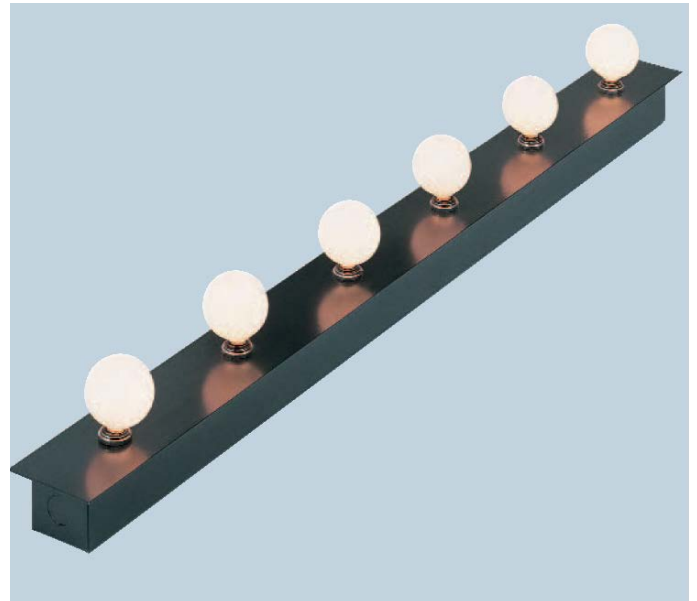

ACCESSORIES AND FABRICATION SHEETS

- A complete line of optional accessories such as baffles, lamp guards, multi-circuiting, decorative end caps and Decora switches and outlets are available. See Accessory Sheet
- Mitered Corner cuts require fabrication information at time of released order. See Mitered Fabrication sheet.
- Custom Baffles can be manufactured to your specifications. See Custom Baffle Fabrication Sheet.

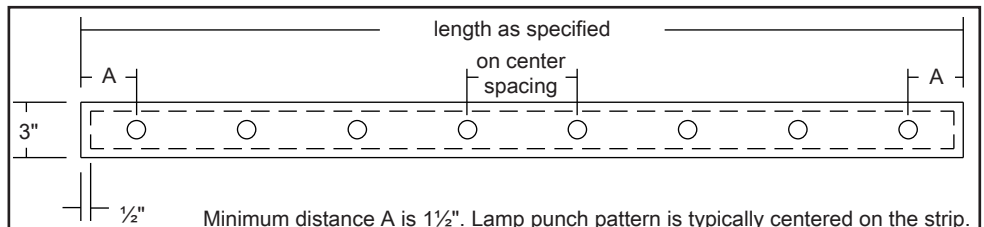

The MQ 2505 is supplied with a faceplate that overlaps the recessed body by 1/2" on all four sides. Bodies are shipped 1" shorter than specified length.

Ordering Format *choose one from each category*

SERIES	LAMP SPACING	FINISH	STRAIGHT or MITERED
MQ 2505 Marquee	<input type="checkbox"/> 6 6" on center	<input type="checkbox"/> SA Satin Aluminum	<input type="checkbox"/> F Straight Footage
	<input type="checkbox"/> 12 12" on center	<input type="checkbox"/> WP White Powder Coat	<input type="checkbox"/> FM Mitered Footage Mitered and applications require a fabrication sheet.
		<input type="checkbox"/> BP Black Powder Coat	
		<input type="checkbox"/> CC Custom Color	



BELFER LIGHTING

PO Box 2079, Ocean NJ 07712

Modifications and custom configurations are available. Please contact our Sales Department.

(732) 493-2666 info@belfer.com www.belfer.com

FORM GEOMETRIC SHAPES. TURN CORNERS. ENHANCE THE PERIMETER OF A BUILDING. MITERING BELFER MARQUEE STRIPS CAN CREATE A VARIETY OF GEOMETRIC SHAPES.

DESIGNED TO PROVIDE FLEXIBILITY IN CREATING LIGHTING EFFECTS. OUR FACTORY CUT MITERS FORM A CLEAN ARCHITECTURAL STATEMENT, NO SPECIAL CONNECTORS ARE NEEDED. NOTHING TAKES AWAY FROM ITS' BEAUTY AND FORM.

A FABRICATION SHEET IS REQUIRED TO ENSURE PROPER ANGLE AND LAMP POSITION.

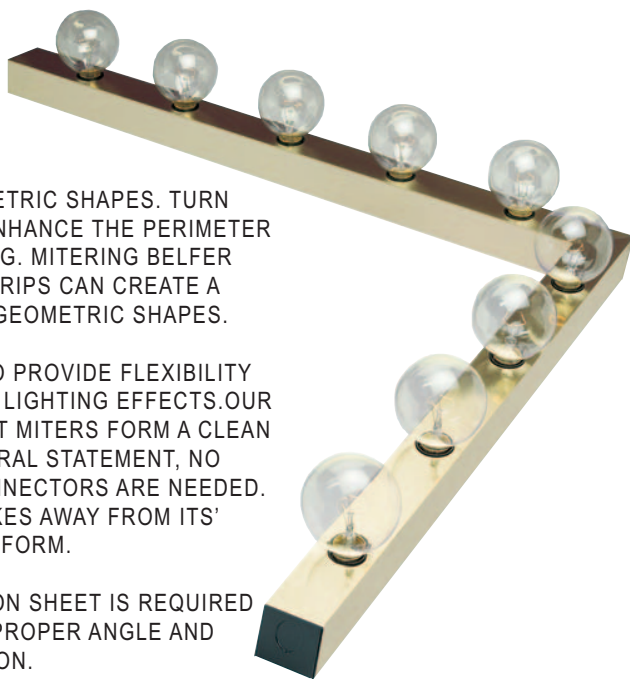

PROJECT

TYPE

CATALOG#

SELECT LAMP ORIENTATION:

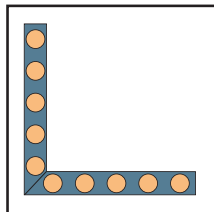

☐ Lamp Up

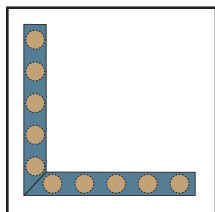

☐ Lamp Down

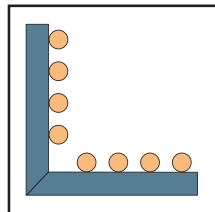

☐ Lamp In

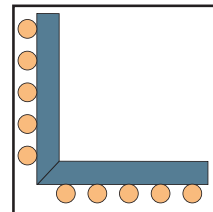

☐ Lamp Out

SELECT MITER CONFIGURATION:

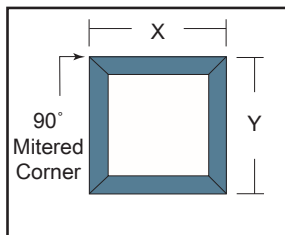

☐ Standard Box Configuration

X = _____
Y = _____

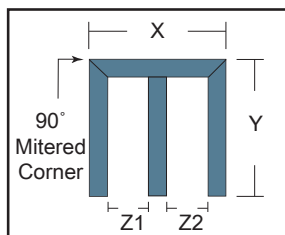

☐ Standard Mirror Configuration

X = _____
Y = _____
Z1 = _____
Z2 = _____

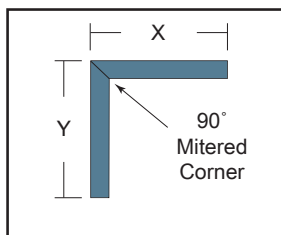

☐ Standard Corner Configuration

X = _____
Y = _____

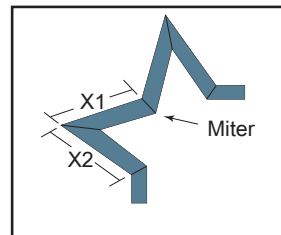

☐ Custom Angle Configuration

Job Plans or Drawings are required



PROJECT

TYPE

CATALOG#

YOUR CUSTOM BAFFLE CAN BE INCORPORATED INTO ANY BELFER MARQUEE FIXTURE.
CHOOSE FROM A STANDARD BAFFLE DESIGN AND SIZE BELOW OR DRAW YOUR OWN TO DISCUSS
THE POSSIBILITIES.
ALL REFLECTORS REQUIRE FIELD DRILLING UNLESS ORDERED WITH THE FIXTURE.

SELECT BAFFLE DESIGN:

BAFFLES	A x B
<input type="checkbox"/> B4B	4"x6" Black
<input type="checkbox"/> B5B	5"x7" Black
<input type="checkbox"/> B2B	2½"x3½" Black
<input type="checkbox"/> BCC	Custom Color Baffle Contact Factory
<input type="checkbox"/> BCB	Custom Baffle Job Plans or Drawings are Required

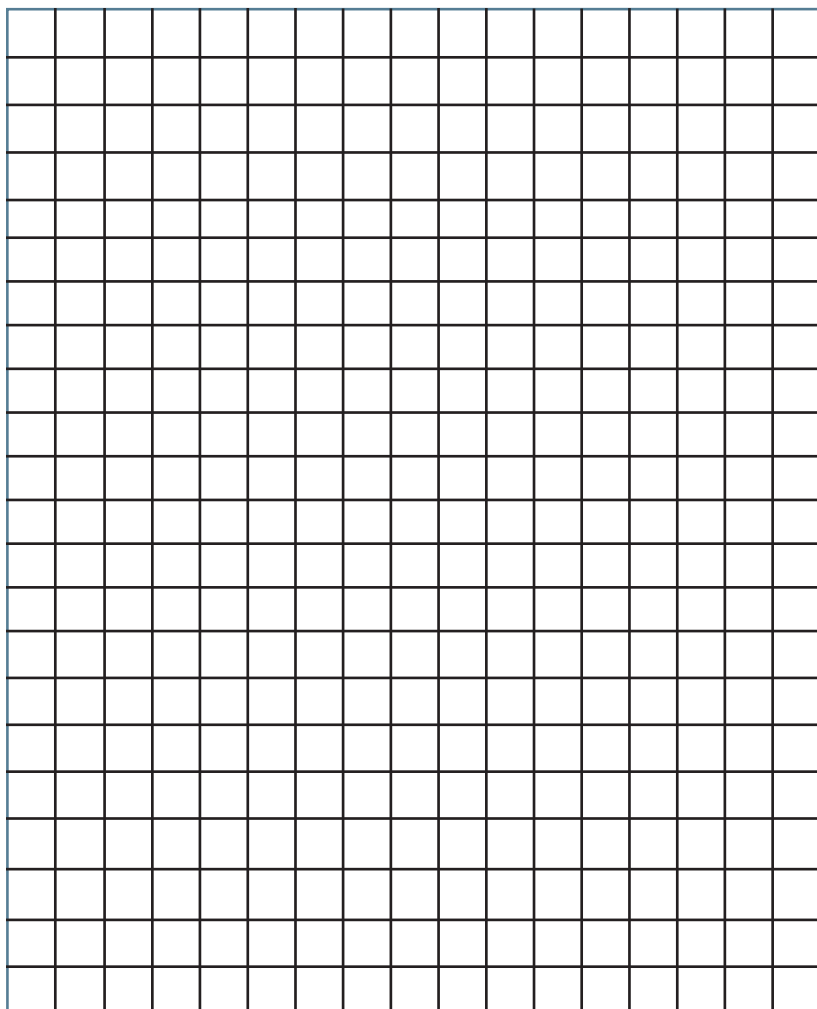
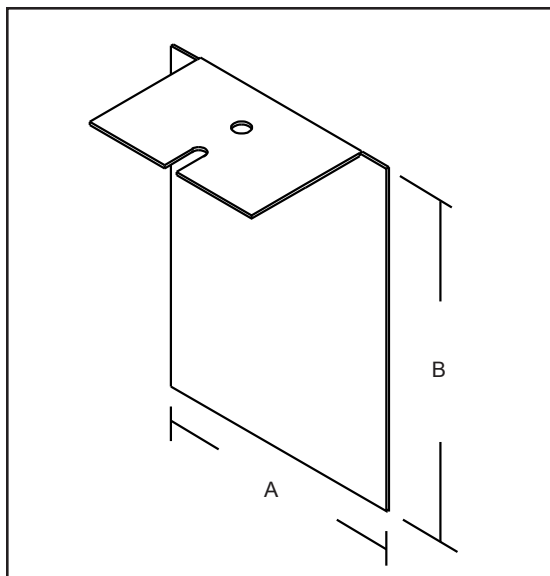

MULTI-CIRCUITING:

Standard product is prewired for single circuit

- ☐ DCT 2 Circuit, Per Foot
- ☐ TCT 3 Circuit, Per Foot
- ☐ QCT 4 Circuit, Per Foot
- ☐ MCT Custom Multi Circuit, Per Foot

NOTE:

- Multi-Circuiting diagram is required
- Multi-Circuiting must be ordered with a MQ 2500 series Marquee strip



SWITCH AND OUTLET:

For MQ 2502 and MQ 2504 Series

- ☐ DSWT Decora Switch, 15 amp White
- ☐ DOWT Decora Outlet, 15 amp White

NOTE:

- Decora switch and outlet for MQ 2502 and MQ 2504 series only
- Field modification required unless ordered with fixture
- Switch and outlet are UL and CUL Listed Damp Location only
- Please indicate placement on fixture with order
- Minimum distance to end of fixture is 2"
- Minimum distance between accessories is 2"
- Minimum distance between accessories and center of nearest socket is 4"

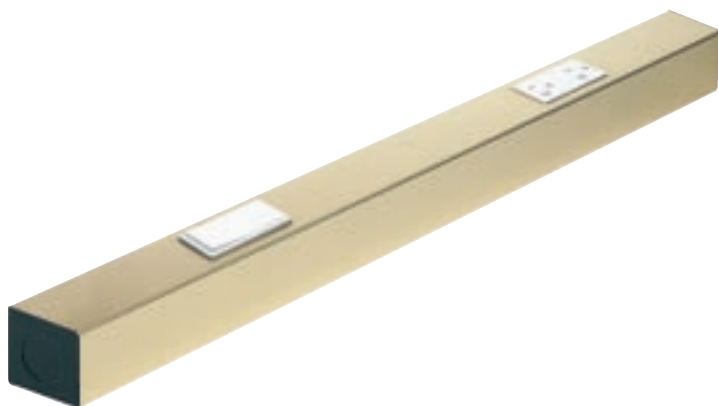

PROJECT

TYPE

CATALOG#

DECORATIVE END CAPS:

For MQ 2501, MQ 2502, MQ 2504 and MQ 2505 Series

- ☐ ECWT 2" White Decorative End Cap
- ☐ ECBK 2" Black Decorative End Cap
- ☐ ECSA 2" Satin Aluminum Decorative End Cap

For MQ 2503 Series

- ☐ EC3WT 1½" White Decorative End Cap
- ☐ EC3BK 1½" Black Decorative End Cap
- ☐ EC3SA 1½" Satin Aluminum Decorative End Cap

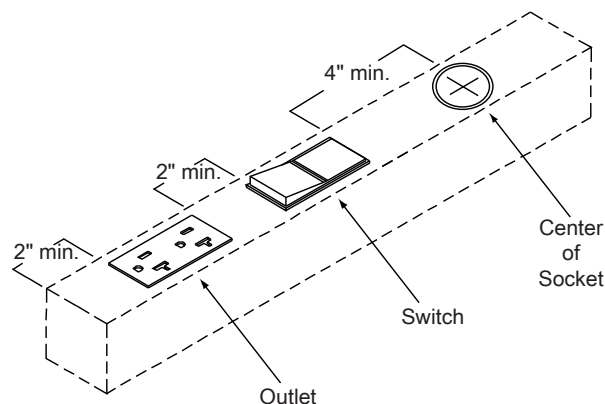



PROJECT

TYPE

CATALOG#

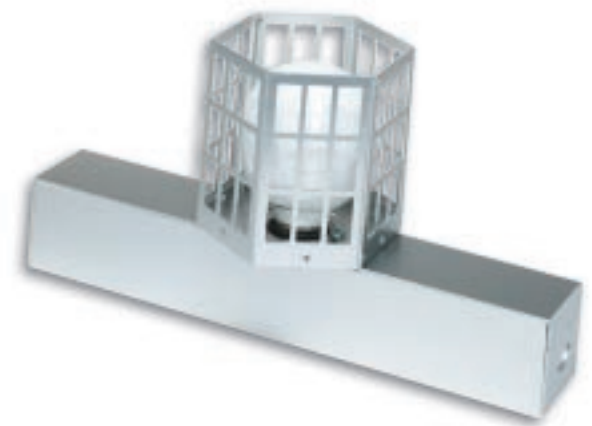

DECORATIVE LAMP GUARDS:

For MQ 2502 and MQ 2504 Series

□ MQLG MQ 2500 Decorative Lamp Guard for Medium Base Lamps, Satin Aluminum

NOTE:

- Decorative Lamp Guards are available for use with MQ 2502 and MQ 2504 marquee light strips only.
- Field drilling is required unless ordered with fixture.

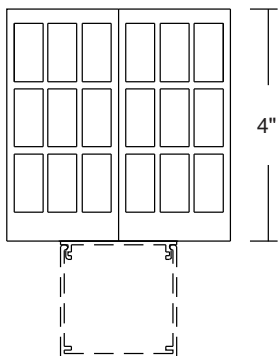

MQ Lamp Guard
Front View

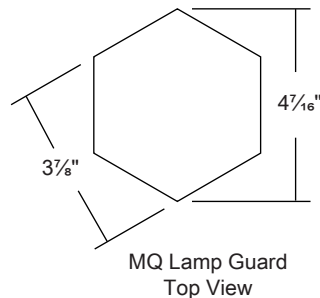

MQ Lamp Guard
Top View

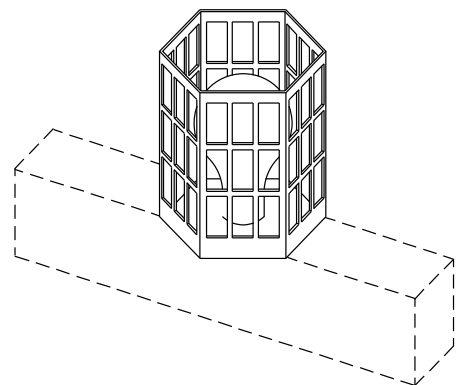

MQ Lamp Guard may be mounted
point perpendicular
or point parallel to extrusion.
(point perpendicular shown)